

# MANUAL OF USE



This manual MUST be given to the user of the product. Read this manual BEFORE using this product, and keep it for future reference.

The information contained in this document is non-binding and subject to change without notice.

*Non-contractual photos*

# Joëlette *and Co*

## by Ferriol-Matrat

www.joeletteandco.com

INTRODUCTION .....	1
FUNCTIONALITY .....	1
GUARANTEE .....	1
THE SOFAO .....	2
DRIVING THE SOFAO .....	2
SPECIFIC DRIVING TECHNIQUE .....	3
<u>At the pool</u> .....	3
<u>At the sea</u> .....	3
PASSENGER INSTALLATION ON THE SOFAO .....	4
<u>The transfer</u> .....	4
<u>Maintaining</u> .....	4
<u>Comfort</u> .....	4
SAFETY RULES .....	4
<u>The team</u> .....	4
<u>Insurance</u> .....	4
<u>During the swim</u> .....	4
EXPLODED VIEW OF THE SOFAO .....	5
MAINTENANCE .....	6
CARE AND MAINTENANCE .....	6
CLEANING .....	6
DESINFECTION .....	6
INSPECTION LIST .....	6
LONG-TERM STORAGE .....	8
AFTER USE .....	8
WASTE MANAGEMENT .....	8
TECHNICAL DATA .....	8
UNFOLDING THE SOFAO .....	11
CONTACT .....	14

# INTRODUCTION

This user's manual contains important information on handling the SOFAO. To ensure safe use of the product, read the user manual carefully and follow the safety instructions.

If the font size of the printed version of the user manual is too difficult for you to read, you can download the manual in PDF format from the website [www.joeletteandco.com](http://www.joeletteandco.com). You can then adjust the font size on the screen to improve your visual comfort.

## **WARNING**

Any serious incident related to the use of the Sofao should be reported to the manufacturer.

USE ONLY FOR LEISURE ACTIVITIES

# FUNCTIONALITY

Only use the Sofao if it is in perfect working order. If it is not, you may endanger yourself and others. The following list is not intended to be exhaustive. It is simply intended to indicate some situations that could affect the functionality of your Sofao.

You should stop using your Sofao if its functionality is impaired for any of the following reasons:

- failure of the backrest locking system (indexing fingers)
- failure of the seat locking system (indexing fingers),
- insufficient tyre pressure,
- damaged floats,
- damaged seat, backrest and leg rest covers,
- damaged retainer,
- damaged, bent, pinched or detached cables,
- missing safety pins (rear wheels),
- abnormal or unusual noises appearing.

# GUARANTEE

The guarantee is 2 years. The SOFAO must be used for its intended purpose, carefully treated and maintained. Risk of accident and loss of warranty in case of improper care and maintenance (page 6).

For safety reasons and to avoid accidents due to unnoticed wear and tear, it is essential that the Sofao is checked several times a year and at least once a year.

If you have a malfunction on your Sofao, do not intervene yourself at risk of loss of warranty, contact us. Spare parts are available for 5 years.

# THE SOFAO

The SOFAO is an amphibian chair which enables a guide to take the passenger from the car to the sea after crossing the beach, without any necessary transfer in between and even without specialized access system.

The guide helps getting in and out of the water safely, thanks to the front handle.

Four floaters with multiple positions allow total immersion up to the shoulders, enabling the passenger to be totally autonomous once into the water. You can also relax, without transfer, because the SOFAO becomes a comfortable deckchair thanks to the adjustable backrest.

The Sofao is entirely foldable without any tools. You can roll it while folded and easily transport it in the boot of a middle-size car in order take it everywhere.

It is designed for a large number of users with different needs.

## DRIVING THE SOFAO

The Sofao can be operated in different ways depending on the options chosen:

- Without an option, the easiest way is to pull the Sofao with the front handle.
- Push the Sofao with the rear handlebar with the pool wheel.
- The Tire-Sofao is intended to pull the Sofao forward. It is advisable to use the extra pair of wheels with this option.



### Adjusting the backrest:

- Stand behind the Sofao holding the top of the cradle.
- Using your foot, press the cable between the wheels and tilt the cradle forward or backward to adjust it to your liking.

## SPECIFIC DRIVING TECHNIQUE

### TO THE POOL

- To go down the stairs of a swimming pool, stand at the back of the Sofao, back to the slope. Step back into the water by holding the chair. To mount them, face the chair and pull it with the handle, to get it out of the water.



*Go down the stairs*



*Go upstairs*



- If the pool has a ramp, position yourself behind the Sofao and walk in the direction of the walk.



- To exit or enter the Sofao into the water, over a curb, hold the Sofao back, through the handlebars, then hold the descent, or pull the chair out of the water. This can be done in pairs, with one person in the front and one in the back.



## **TO THE SEA**

Check that the water is easily accessible. If the sand is loose, we recommend the use of the additional pair of wheels (optional), to facilitate the chair handling.

# PASSENGER INSTALLATION ON THE SOFAO

## THE TRANSFER

If the passenger is unable to transfer himself or herself from the wheelchair to the Sofao, carry the passenger and place him or her in the swimming chair.

## THE MAINTAINING

Before each swim or move, attach the safety straps to the passenger's legs and chest.

## COMFORT

Before moving, adjust the seat back tilt to ensure the best possible comfort for the passenger.

## SAFETY RULES

### THE TEAM

Only one pilot is required to drive the Sofao. At sea, a second pilot must be present to prevent the chair from drifting.

### INSURANCE

It is mandatory for each attendant to have a liability insurance. The use of Sofao does not require specific insurance, but this practice must be reported to your insurer.

### DURING THE SWIM

- Follow the instructions given by lifeguards.
- Check marine weather and do not use SOFAO in case of swell, wave, wind...
- The attendant should always keep one hand on the Sofao.
- Do not swim outside supervised swimming areas.
- An attendant must always be near the chair. At sea, a second attendant must be present to prevent the chair from drifting.



EXPLODED VIEW OF THE SOFAO

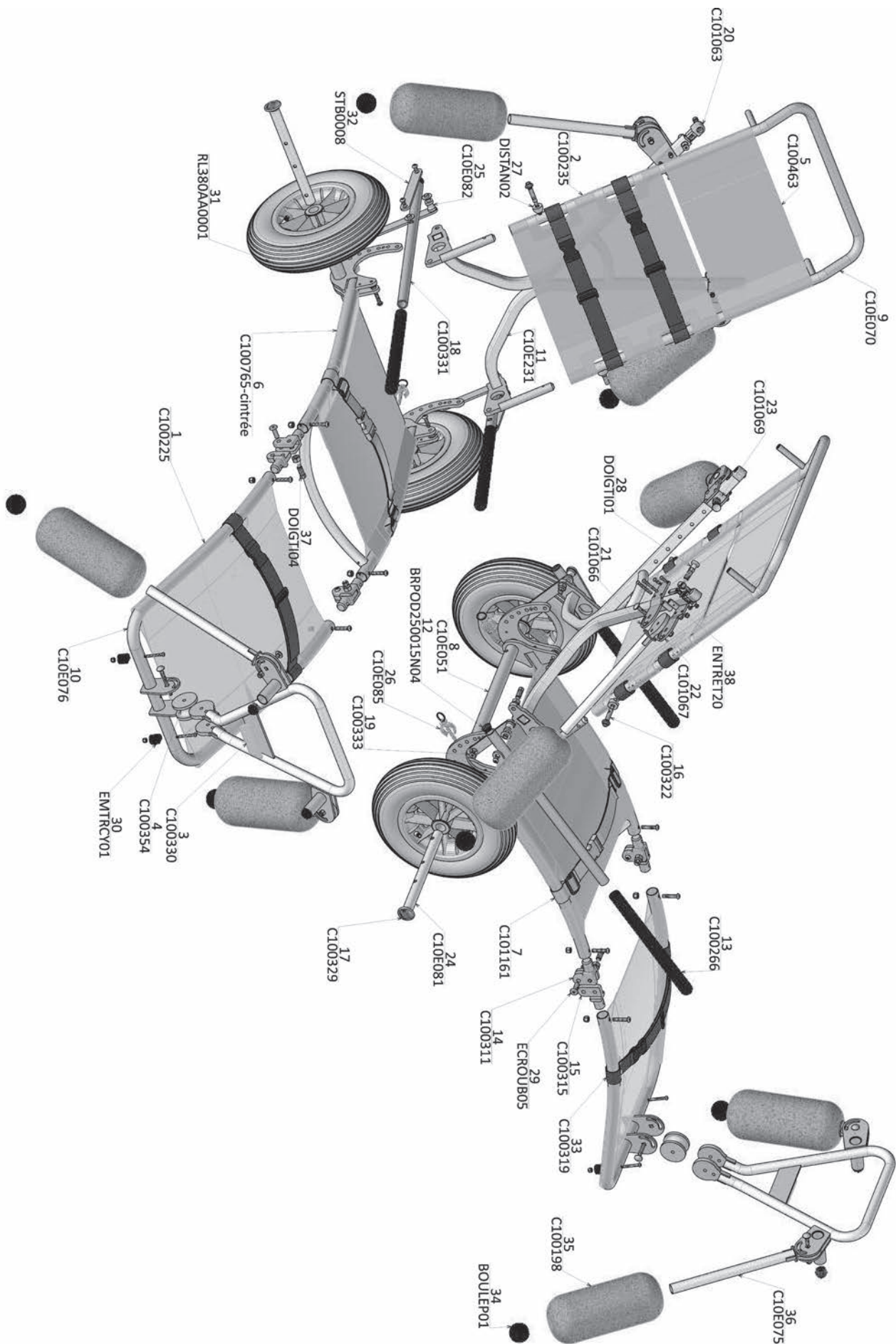

# MAINTENANCE

## CARE AND MAINTENANCE

The term «Maintenance» is suitable for any activity that will keep the Sofao in good condition and ensure its fitness for travel. Maintenance includes various areas such as regular cleaning, inspections, repairs and general overhauls.

It must be done at least once a year regardless of the frequency of use. A second maintenance is necessary in case of regular use (several times a week).

It consists in checking:

- tire pressure
- the presence of safety pins.

## CLEANING

When cleaning the Sofao, observe the following points:

- Rinse the chair after each use to reduce the corrosive effect of salt or chlorine.
- Do not use abrasives for cleaning.
- Do not use high-pressure cleaning equipment.

## DESINFECTION

Disinfection using disinfectant products tested and recognized on a damp cloth or by vaporization is permitted. The Robert Koch Institute at <http://www.rki.de> has a list of disinfectant products currently authorized for wet or vaporized cleaning.

## INSPECTION LIST

The following tables provide a list of inspections that the user will need to perform at the corresponding intervals.



**Before each use of the Sofao**

ELEMENT	INSPECTION CHECK	IN CASE OF FAILURE
Seat locking system seat lock	Make sure that the movement of the indexing fingers is free without jamming and that the seat locks properly.	Contact us
	Make sure the index finger is tight on the joints.	Tighten the index finger using 12 and 19 flat spanners
Tyres	Check that the tyres are not damaged and that there are no leaks in the inflation valves.	Contact us
	Make sure the tyre is inflated to the correct pressure.	Inflate the tyre. Refer to the main wheel tyre table in the «Technical data» chapter. To repair the inner tube, contact us or a bicycle dealer.
Presence of pins and safety pins	Ensure that the wheel axle pins are present.	Contact us
Holding device	Make sure that the belt buckles do their job properly. Check that the seams are not damaged.	Contact us

**Regularly**

ELEMENT	INSPECTION CHECK	IN CASE OF FAILURE
All Bayline fabrics	Check for damage and wear. Check that the seat zips are closed properly.	Contact us

**LONG TERM STORAGE**

If you do not use your Sofao for a long period of time, you should prepare it for storage to increase its life span.

We recommend storing the Sofao at a temperature of 15°C and avoiding extreme temperatures to extend the life of the Sofao and its accessories.

The components are tested and approved for higher temperature ranges, detailed below:

- The permissible temperature range for storing the vehicle is -20°C to +40°C.

Store in a dry, well-ventilated environment protected from external influences.

Slightly over-inflate the tyre.

# AFTER USE

## WASTE MANAGEMENT

- The packaging of the appliances goes to material recycling.
- Metal parts go to scrap metal recycling.
- Plastic parts go to plastic recycling.
- The waste management must be carried out in accordance with the respective national legal regulations.

## TECHNICAL DATA

The technical information provided in this document applies to the standard configuration for the Sofao or represents the theoretical maximum values.

These characteristics may change if accessories are added.

Nb: Please note that in some cases the measured values may vary by +/- 10mm.

AUTHORISED CONDITIONS AND PLACES OF USE AND STORAGE	
Operating temperature range	From -10 to +50°C
Storage temperature range	From 0 to +50°C

TYRES	
Tyre type	8" x 3,5", tyre
Pressure	2,5 bar

TYRES	
Total height	1140 - 692 mm (backrest up - reclining)
Total width	754 mm
Total length	1560 - 2455 mm (backrest up - reclining)
Seat height	295 mm
Seat width	495 mm

Seat depth	530 mm
Backrest height	510 mm
Backrest angle	90 / 100 / 110 / 120 / 130 / 140 °
Seat angle	9°
Armrest height	200 mm
Armrest length	335 mm
Ground clearance	154 mm
Storage dimensions	1035 (length) x 610 (width) x 475 (height)

WEIGHT	
Tare weight	17 kg

LOAD	
Max. load	100 Kg



# UNFOLDING THE SOFAO



1. Remove the safety pins from the wheel axles.



2. Remove the wheel axles.



3. Slide the wheels onto their axles, with the valve facing outwards, then replace the axles in their housing.



4. Replace the safety pins.



5. Unfold the folder



6. Unfold the seat





7. Press down on the seat cable to align the two parts.



8. Before swimming, unfold the four floaters

To fold the Sofao, proceed in reverse order.

A video is available on our website [www.joeletteandco.com](http://www.joeletteandco.com)



*Joëlette and Co*  
*by Ferriol-Matrat*

Fabriqués par / *manufactured by*

*FERRIOL-MATRAT*  
*ZI CHARLES CHANA*  
*3 RUE DE LA GALERIE*  
*42230 ROCHE LA MOLIERE - FRANCE*

FERRIOL-MATRAT - ZI Charles Chana – 3 rue de la Galerie 42230 Roche la Molière

**Tel:** +33 (0)4.77.42.62.58 / **Fax :** 33(0)4.77.37.72.79

**Mail :** [export@joeletteandco.com](mailto:export@joeletteandco.com)

SARI au capital de 500 000 € - SIRET 423 501 055 00028 – APE: 2550B - TVA : FR 87 423501 55

# CONTACT

**DO NOT HESITATE TO CONTACT THE JOËLETTE AND CO TEAM  
FOR ANY QUESTION**



[export@joëletteandco.com](mailto:export@joëletteandco.com)

**After Sales Service : [jc-odin@joëletteandco.com](mailto:jc-odin@joëletteandco.com)**



**0033 (0)4 - 77 - 42 - 62 – 58**

Join the Joëlette's Community on social networks!



**@FERRIOL-MATRAT – ALL RIGHTS RESERVED**

*This manual is protected by the law of 11 March 1957 on literary and artistic property, supplemented by the law of 3 July 1985 and by all conventions applicable to copyright. In application of these laws and conventions, no reproduction, total or partial copy of the manual, programs or systems is authorised without the prior written consent of FERRIOL-MATRAT. FERRIOL-MATRAT reserves the right to revise and improve these products. This publication describes the state of the product at the time of publication and does not prejudge any changes that may be made to it.*